



MESSE ESSEN

HYGIENE CONCEPT

OUR GUIDANCE FOR VISITORS

MESSE
ESSEN

YOUR SAFETY IS OUR MAIN PRIORITY

We are pleased that by implementing a few simple measures we are able to work with our exhibitors to again organise successful trade fairs and welcome you to Messe Essen.

For your safety, we constantly adapt our proven hygiene and protection concept to any changes in the Coronavirus Protection Ordinance of the State of North Rhine-Westphalia.

This brochure shows you at a glance what protective measures apply when you attend a trade fair at Messe Essen and how you can protect yourself and other visitors. Our aim is to ensure your safety and well-being during your time here.

We appreciate your collaboration in preparing for your trade fair visit and complying with the hygiene measures.

Enjoy your visit.

With thanks from your Messe Essen team

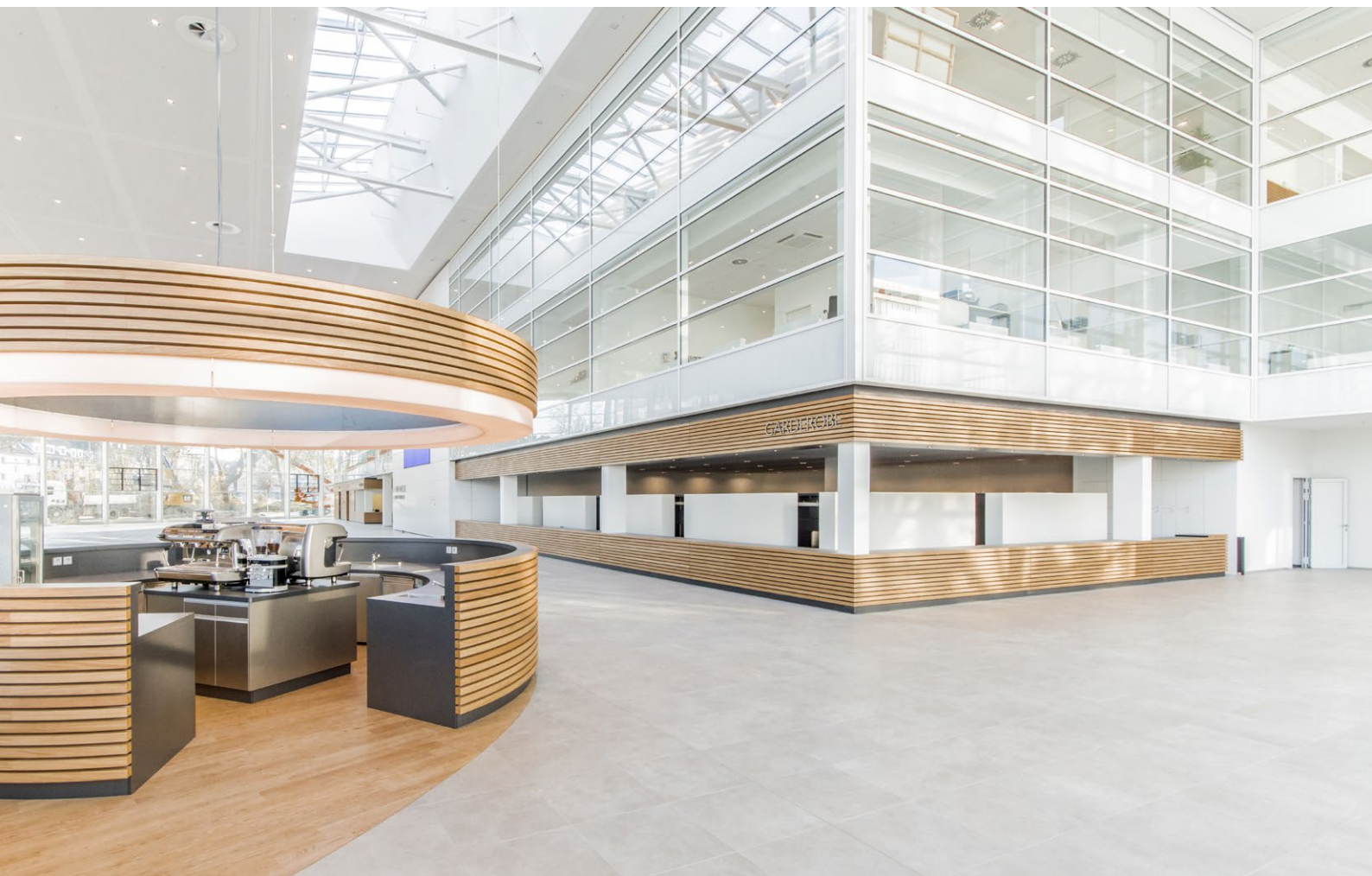

SAFETY RIGHT FROM THE START

ENTRY REQUIREMENTS



You will only be able to enter the exhibition centre if you have proof of vaccination, testing or recovery, as outlined below:

- You have been vaccinated against COVID-19 in accordance with section 3 of the Coronavirus Protection Ordinance and can provide valid documentary proof of this at the entrance to the trade fair site on the day you are attending an event;
- You have recovered from a COVID-19 infection and can provide documentary proof of a positive PCR test (or other nucleic acid test) that was performed at least 28 days but no earlier than 6 months ago;
- You can provide proof of a negative test in accordance with section 7 of the Coronavirus Protection Ordinance at the entrance to the trade fair site on the day you are attending an event.

If you do not have documentary proof of one of the above, you may get tested at a test centre close to the trade fair site. To avoid delays, we recommend that you have the requisite proof (vaccination, test, recovery) in a digital format that is suitable for scanning with the CovPassCheck app.

TICKET PURCHASE AND ACCESS CONTROL



The number of admission tickets for our trade fairs is restricted by the limit on the number of visitors allowed at the exhibition centre. You must purchase your ticket in advance online.



Depending on the event, we offer full-day and/or half-day tickets. You decide how much time you wish to spend at the trade fair of your choice. All admission tickets are dated and are valid for that date. Admission vouchers can only be redeemed online and exchanged for dated tickets. It is not possible to exchange or redeem vouchers at the exhibition centre.



Access to the exhibition centre is a two-stage process. To start with, your proof of vaccination, testing or recovery (see above) will be checked in a covered area outside the entrance. Please have this proof and a photographic identity document (passport, ID card or driving licence) ready for checking.

Your ticket will then be scanned at the entrance to the exhibition halls. Our Hygiene Scouts will be on hand during this process to answer any questions you may have.

WE'RE READY TO WELCOME YOU

ENSURING YOUR SAFETY AT THE EXHIBITION CENTRE



Our doors are open to you, with separate entrances and exits to ensure your safety.



Cashless and contact-free payment (e.g. of parking tickets or in restaurants) is possible.



Floor markings and signs help guide you around the exhibition centre.



Transparent screens, broad aisles and generously designed exhibition spaces and meeting booths create a safe atmosphere, making it easy for you to comply with hygiene measures and keep your distance from other visitors. In addition, we work with our exhibitors to ensure that contact surfaces such as counters, tables and door handles as well as our toilet facilities are cleaned regularly.



We have installed a large number of hand sanitiser dispensers and hand-washing facilities throughout the site.



Our state-of-the-art ventilation systems reduce the number of pathogens in the air inside the exhibition centre. Open doors to the outside also ensure fresh air inside the buildings.



Our restaurants apply the general rules for the catering sector that you are already familiar with. These include being able to remove your surgical face mask once you are seated and registering your contact details. At our Snack Points, the same distancing rules apply as in bakeries and snack bars elsewhere.

WE NEED YOUR HELP HYGIENE AND PROTECTIVE MEASURES FOR EVERYONE

The Messe Essen hygiene concept consists of simple measures that everyone can implement in order to protect themselves and others. Our large team of Hygiene Scouts is out and about during events at the exhibition centre. Please speak to one of them if you have any questions or comments about our hygiene concept. The Hygiene Scouts are there to keep you safe by ensuring that everyone complies with the hygiene rules and that no crowds gather, for example.



Please always stay at least 1.5 metres from other people.



For the protection of all visitors, surgical face masks must be worn in the exhibition halls.

There are exceptions:

- In outdoor spaces
- When seated in catering facilities, restaurants or Coffee Points



Please wash and disinfect your hands thoroughly at regular intervals. You will find hand sanitiser dispensers throughout the site.



Please cough and sneeze into the crook of your arm or use a tissue.



You may not attend an event if any of the following apply:

- You have had contact with a Covid-19 patient in the last 14 days.
- You are suffering from acute and non-specific general symptoms, cold symptoms or respiratory symptoms.
- If you have entered Germany from another country in the past 14 days, please ensure you observe the applicable entry requirements (e.g. quarantine and testing) prior to attending a trade fair.